

## Flow Monitor

# RVM/U-S4



H<sub>2</sub>O

## OVERVIEW

### Operation

- Float measuring principle

### Application

- Cooling systems and cooling circuits
- Mechanical engineering
- Medical engineering
- Pharmaceutical industry
- Chemical industry
- Research & Development

### Features

- Universal orientation
- High reliability
- High switch accuracy
- Infinitely variable switch point adjustment by operator
- Hose connection

### Installation information

- The operating instructions for RVM/U-S4 Module BASICS must be observed!
- **Download: [www.meister-flow.com](http://www.meister-flow.com)**

## OPERATING DATA

<b>Operating pressure, max.</b>	16 bar (Brass version)
<b>Pressure drop</b>	0,02 – 0,2 bar
<b>Temperature, max.</b>	100 °C (optional 160 °C)
<b>Measuring accuracy</b>	±10 % of full scale

## MEASURING RANGES

Type	Switch range for H <sub>2</sub> O at 20 °C <sup>(1)</sup>		
	l/min	gph	gpm
RVM/U-S4/01	0,005 – 0,06	0,08 – 0,95	
RVM/U-S4/02	0,04 – 0,13	0,65 – 2,05	
RVM/U-S4/06	0,1 – 0,6	1,6 – 9,5	
RVM/U-S4/1	0,2 – 1,2	3,0 – 19,0	
RVM/U-S4/2	0,4 – 2	6,5 – 31,5	
RVM/U-S4/3	0,5 – 3	8 – 48	
RVM/U-S4/5	1 – 5	16 – 80	

<sup>(1)</sup> The specified measuring- / switch ranges are valid for water having a density of 1.00 kg/dm<sup>3</sup>, vertical installation of the device and flow direction from bottom to top.

Other installation positions or deviation from the operating densities will increase the measurement error specified in the data sheet.

Operating density for water at 20 °C and 1.013 bar (absolute value): 1.00 kg/dm<sup>3</sup>.

Upon request, special scales for deviating media, different operating conditions and installation positions (only for devices which can be installed in any position) are available.

The specified switch values are switch-off points, i.e. switch values by decreasing flow.

Other measuring- /switch ranges are available upon request.

## MATERIALS

### Brass version, wetted parts

Spring:	1.4571
Magnets:	Hard ferrite
Device body:	Brass
Gaskets:	NBR (optional FKM, EPDM)
all other wetted parts:	Brass

## TECHNICAL DRAWING

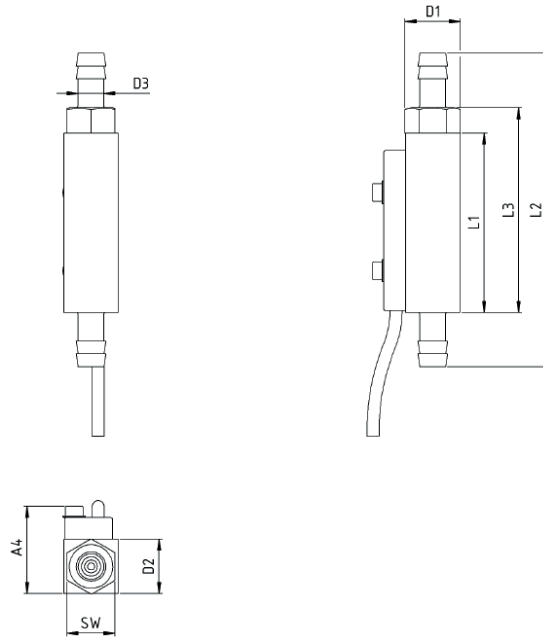

## SUMMARY OF TYPES

Type	Overall dimensions [mm]												Weight approx. [g]
	G	DN	SW	L1	L2	L3	D1	D2	D3	A2	A3	A4	
RVM/U-S4/01 –	8	15	56	98	64	17,3	17	8	–	–	28	160	
RVM/U-S4/02 –	8	15	56	98	64	17,3	17	8	–	–	28	160	
RVM/U-S4/06 –	8	15	56	98	64	17,3	17	8	–	–	28	160	
RVM/U-S4/1 –	8	15	56	98	64	17,3	17	8	–	–	28	160	
RVM/U-S4/2 –	8	15	56	98	64	17,3	17	8	–	–	28	160	
RVM/U-S4/3 –	8	15	56	98	64	17,3	17	8	–	–	28	160	
RVM/U-S4/5 –	8	15	56	98	64	17,3	17	8	–	–	28	160	

## ELECTRICAL DATA

<b>Normally open (NOC)</b>	140V AC · 0,7A · 20VA
	200V DC · 1A · 20VA

## ELECTRICAL CONNECTION

- Cable (1 m)

### Ingress Protection

IP67: Cable

### Output signal

The contact opens when the flow decreases below the set point.

### Power supply

Not required (potential-free reed contacts)

### Connector types

Other cable lengths on request

## CONNECTION DIAGRAM

**Braun  
brown  
marron**

**2**

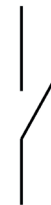

**1**

**Schwarz  
black  
noir**