



**BOURDON**  
The Original by Baumer

EN-  
837-3



## Main Features

- Low pressure measurements
- Class 1.6 according to EN 837-3
- For clean and non corrosive gases

## Applications

- Laboratory & Medical
- Machinery

## Technical Data

Nominal size	MTA2 : 50 mm MTA3 : 63 mm
Measurement ranges	0 ... 60 to 0 ... 600 mbar and corresponding vacuum and compound pressure ranges
Pressure limitation	Steady : 75% of full scale value Fluctuating : 65% of full scale value Short time : 100% of full scale value
Accuracy	Class 1.6 (according EN837-3)
Protection rating (EN 60529)	IP 44 (Type B-F-G) IP 33 (Type D)
Process connection	Brass
Capsule	Bronze / Brass
Case	Stainless steel 1.4301 (AISI 304)
Bezel ring	Stainless steel 1.4301 (AISI 304) (type G)
Movement	Brass
Window	Polycarbonate, snap-fitted into the case
Dial	Aluminium, white
Pointer	Aluminium, black
Temperature	Ambient: -20...60°C Medium: -20...60°C Storage: -40...70°C
Thermal drift	± 0.4 % F.S. / 10 K (reference 20°C)
Zero adjustment	± 10 % of full scale value Adjustment screw accessible on the front side after removing of the window or the rubber plug in the window (type G)

## Dimensions - Types of mounting

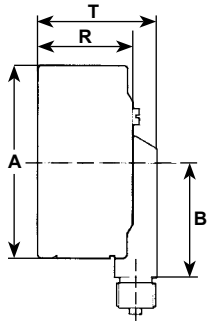

**Type D**

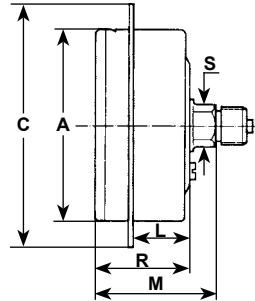

**Type B**

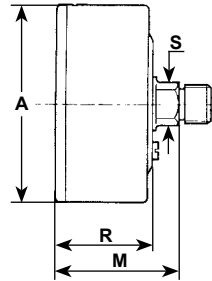

**Type F**

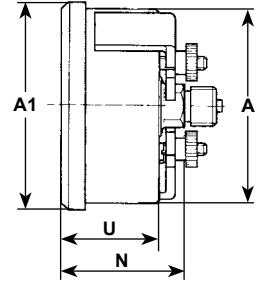

**Type G**

Ø mm	A	A1	B	C	L	M	N	R	T	S	U	Weight (kg)
NS 50	51	55.6	31.5	68	18.5	38	39.5	29.5	37.5	14	31	0.130
NS 63	63	67.6	37.6	81	18.5	39	39.5	30.5	38.5	14	31	0.160

## Pressure ranges

Code	mbar
N53	-60 ... 0
N54	-100 ... 0
N55	-160 ... 0
N56	-250 ... 0
N57	-400 ... 0
N58	-600 ... 0
N07	0 ... 60
N08	0 ... 100
N09	0 ... 160
N10	0 ... 250
N11	0 ... 400
N12	0 ... 600
N64	-25 ... 40
N65	-40 ... 60
N66	-60 ... 100
N67	-100 ... 160
N68	-160 ... 250
N69	-250 ... 400

Code	mmH <sub>2</sub> O
R53	-600 ... 0
R54	-1000 ... 0
R55	-1600 ... 0
R56	-2500 ... 0
R57	-4000 ... 0
R58	-6000 ... 0
R07	0 ... 600
R08	0 ... 1000
R09	0 ... 1600
R10	0 ... 2500
R11	0 ... 4000
R12	0 ... 6000
R64	-250 ... 400
R65	-400 ... 600
R66	-600 ... 1000
R67	-1000 ... 1600
R68	-1600 ... 2500
R69	-2500 ... 4000

Code	inH <sub>2</sub> O
Z53	-25 ... 0
Z54	-40 ... 0
Z55	-60 ... 0
Z56	-100 ... 0
Z57	-160 ... 0
Z58	-250 ... 0
Z07	0 ... 25
Z08	0 ... 40
Z09	0 ... 60
Z10	0 ... 100
Z11	0 ... 160
Z12	0 ... 250
Z64	-10 ... 16
Z65	-16 ... 25
Z66	-25 ... 40
Z67	-40 ... 60
Z68	-60 ... 100
Z69	-100 ... 160

## Ordering details MTA2 - MTA3

	MTA	-			.	xxx
<b>Model</b>	MTA					
Capsule pressure gauge						
<b>Nominal size</b>						
50 mm			2			
63 mm			3			
			-			
<b>Type of mounting</b>						
Back connection, front flange, 3 mounting holes						B
Bottom connection						D
Back connection						F
Back connection with clamp						G
<b>Process connection</b>						
G 1/4					2	
1/4 NPT					5	
<b>Liquid filling</b>						
Dry						0
						.
<b>Unit of measurement / Pressure ranges <sup>(1)</sup></b>						
mbar						Nxx
mmH <sub>2</sub> O						Rxx
inH <sub>2</sub> O						Zxx

<sup>(1)</sup> Available standard pressures ranges, see tables on page 2. For ranges not listed, please contact Baumer.

## Ordering example

